

Series 1500 *Windows*



- Durability
- Efficiency
- Value



Columbia
Windows & Doors

The Builders' Choice in Vinyl Windows

Series 1500 *Prime Window*

The Series 1500 prime window is an affordable, fully welded vinyl window system designed with both the home-builder and the home-owner in mind. Easily installed, these windows are exceptionally durable, require little or no maintenance, are simple to clean and enhance a home's energy efficiency.

Vinyl windows are rapidly becoming the builder's — and consumer's — window of choice. Home builders prefer vinyl's ease of installation, sturdiness and ability to withstand construction-site rigors. Home-buyers appreciate vinyl window's energy efficiency, lasting good looks, smooth operation and ease of cleaning.

Series 1500 single-hung, Series 1400 horizontal sliding and Series 1510 picture windows are available with white or almond frames. Featuring fully welded frame and sash corners and multi-chambered construction, these durable windows offer exceptional weather-tightness and superior thermal performance. And because they're vinyl, they will never need painting, stripping, sanding or lubricating.

Features

- Impact, corrosion and weather resistant vinyl construction.
- Decorator preferred colors are integral throughout the vinyl; never needs painting, hides scratches and comes clean with a damp cloth.
- Multi-chambered construction provides strength and insulation.
- Fusion welded frame and sash corners for added strength and clean looks.
- Integral pre-punched 1-1/4" nailer fins for fast installation; prevention of air and water leakage; easy multiple-unit mulling and stacking.
- Single-hung windows tilt in for easy cleaning from inside the home. Horizontal sliders feature an easily removable sash.
- Snap-in inside glazing bead for easy glass installation or replacement.
- Nominal 7/8" insulating, energy-efficient glass. Low-E and tinted glass options available.
- Unique stepped sill for strength, reduced sight lines and added security.
- Continuous sash handle for ease of operation. Optional automatic snap lock provides added security.
- Weatherstripped interlock to assure a tight seal.
- Covered weep holes in sill control rain-water drainage.



SERIES 1500

Tilt Single Hung

Available in Standard and Oriel formats and with a variety of muntin patterns. Featuring a fixed top lite and nominal 7/8" insulated glass, the Series 1500 Single Hung bottom sash uses weight-regulated balances that permit tilting-in of the lower sash for easy cleaning.

Applicable Standards:

- Structural: Grade 30
- Forced Entry Resistance: Passed



Standard Sizes

Standard Window Size	Rough Opening		Actual Size		Glass Size		Screen Size		Divided Light Config.	
	Single Unit		Twin Unit	Single Unit		Width	Height	Width		Height
	Width	Height	Width	Width	Height					
2026	24	30	47-1/2	23-1/2	29-1/2	19-3/8	12-1/4	19-1/2	12-3/16	4/4
2030		36			35-1/2		15-1/4		15-3/16	
2038		44			43-1/2		19-1/4		19-3/16	
2040		48			47-1/2		21-1/4		21-3/16	
2044		52			51-1/2		23-1/4		23-3/16	
2050		60			59-1/2		27-1/4		27-3/16	
2056		66			65-1/2		30-1/4		30-3/16	
2060		72			71-1/2		33-1/4		33-3/16	
2426	28	30	55-1/2	27-1/2	29-1/2	23-3/8	12-1/4	23-1/2	12-3/16	6/6
2430		36			35-1/2		15-1/4		15-3/16	
2438		44			43-1/2		19-1/4		19-3/16	
2440		48			47-1/2		21-1/4		21-3/16	
2444		52			51-1/2		23-1/4		23-3/16	
2450		60			59-1/2		27-1/4		27-3/16	
2456		66			65-1/2		30-1/4		30-3/16	
2460		72			71-1/2		33-1/4		33-3/16	
2826	32	30	63-1/2	31-1/2	29-1/2	27-3/8	12-1/4	27-1/2	12-3/16	6/6
2830		36			35-1/2		15-1/4		15-3/16	
2838		44			43-1/2		19-1/4		19-3/16	
2840		48			47-1/2		21-1/4		21-3/16	
2844		52			51-1/2		23-1/4		23-3/16	
2850		60			59-1/2		27-1/4		27-3/16	
2856		66			65-1/2		30-1/4		30-3/16	
2860		72			71-1/2		33-1/4		33-3/16	
3026	36	30	71-1/2	35-1/2	29-1/2	31-3/8	12-1/4	31-1/2	12-3/16	6/6
3030		36			35-1/2		15-1/4		15-3/16	
3038		44			43-1/2		19-1/4		19-3/16	
3040		48			47-1/2		21-1/4		21-3/16	
3044		52			51-1/2		23-1/4		23-3/16	
3050		60			59-1/2		27-1/4		27-3/16	
3056*		66			65-1/2		30-1/4		30-3/16	
3060*		72			71-1/2		33-1/4		33-3/16	
3426	40	30	79-1/2	39-1/2	29-1/2	35-3/8	12-1/4	35-1/2	12-3/16	8/8
3430		36			35-1/2		15-1/4		15-3/16	
3438		44			43-1/2		19-1/4		19-3/16	
3440		48			47-1/2		21-1/4		21-3/16	
3444		52			51-1/2		23-1/4		23-3/16	
3450*		60			59-1/2		27-1/4		27-3/16	
3456*		66			65-1/2		30-1/4		30-3/16	
3460*		72			71-1/2		33-1/4		33-3/16	
3826	44	30	87-1/2	43-1/2	29-1/2	39-3/8	12-1/4	39-1/2	12-3/16	8/8
3830		36			35-1/2		15-1/4		15-3/16	
3838		44			43-1/2		19-1/4		19-3/16	
3840		48			47-1/2		21-1/4		21-3/16	
3844		52			51-1/2		23-1/4		23-3/16	
3850*		60			59-1/2		27-1/4		27-3/16	
3856*		66			65-1/2		30-1/4		30-3/16	
3860*		72			71-1/2		33-1/4		33-3/16	

VERTICAL DETAIL

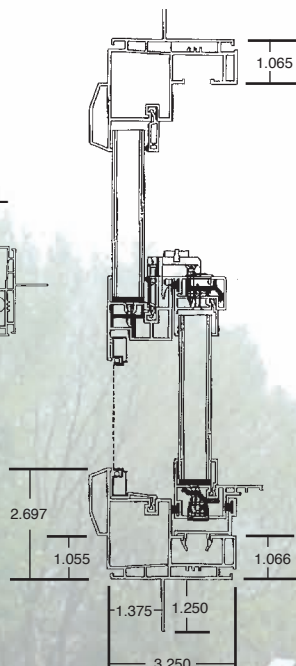

HORIZONTAL DETAIL

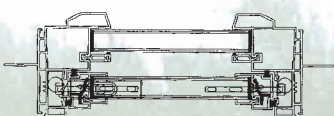

*Meet egress requirements.

SERIES 1400

Horizontal Sliders

Features easy-lift-out sash for quick cleaning. Corrosion-resistant nylon slides ensure a long life of smooth, quiet operation. Series 1400 horizontal sliders are available in 2-lite or 3-lite end vent configurations.

Applicable Standards:

- Structural: Grade 30
- Forced Entry Resistance: Passed



Primary - Standard Sizes

Standard Window Size	Rough Opening		Actual Size		Glass Size		Screen Size	
	Single Unit		Single Unit		Width	Height	Width	Height
	Width	Height	Width	Height				
2020	24	24	23-1/2	23-1/2	9-5/8	19-1/4	9-1/16	19-1/2
2030		36		35-1/2		31-1/4		31-1/2
2040		48		47-1/2		43-1/4		43-1/2
2050		60		59-1/2		55-1/4		55-1/2
3020	36	24	35-1/2	23-1/2	15-5/8	19-1/4	15-1/16	19-1/2
3030		36		35-1/2		31-1/4		31-1/2
3040		48		47-1/2		43-1/4		43-1/2
3050		60		59-1/2		55-1/4		55-1/2
4020	48	24	47-1/2	23-1/2	21-5/8	19-1/4	21-1/16	19-1/2
4030		36		35-1/2		31-1/4		31-1/2
4040		48		47-1/2		43-1/4		43-1/2
4050		60		59-1/2		55-1/4		55-1/2
5020	60	24	59-1/2	23-1/2	27-5/8	19-1/4	27-1/16	19-1/2
5030		36		35-1/2		31-1/4		31-1/2
5040*		48		47-1/2		43-1/4		43-1/2
5050*		60		59-1/2		55-1/4		55-1/2
6020	72	24	71-1/2	23-1/2	33-5/8	19-1/4	33-1/16	19-1/2
6030*		36		35-1/2		31-1/4		31-1/2
6040*		48		47-1/2		43-1/4		43-1/2
6050*		60		59-1/2		55-1/4		55-1/2

*Meet egress requirements.

End Vents - Standard Sizes

Standard Window Size	Rough Opening		Actual Size		Glass Size				Screen Size	
	Single Unit		Single Unit		Fixed		Operation		Width	Height
	Width	Height	Width	Height	Width	Height	Width	Height		
6020	72	24	71-1/2	23-1/2	33-5/8	19-1/4	16-9/16	19-1/4	16-1/16	19-1/2
6030		36		35-1/2		31-1/4		31-1/4		31-1/2
6040		48		47-1/2		43-1/4		43-1/4		43-1/2
6050		60		59-1/2		55-1/4		55-1/4		55-1/2
7020	84	24	83-1/2	23-1/2	39-5/8	19-1/4	19-9/16	19-1/4	19-1/16	19-1/2
7030		36		35-1/2		31-1/4		31-1/4		31-1/2
7040		48		47-1/2		43-1/4		43-1/4		43-1/2
7050		60		59-1/2		55-1/4		55-1/4		55-1/2
8020	96	24	95-1/2	23-1/2	45-5/8	19-1/4	22-9/16	19-1/4	22-1/16	19-1/2
8030		36		35-1/2		31-1/4		31-1/4		31-1/2
8040		48		47-1/2		43-1/4		43-1/4		43-1/2
8050		60		59-1/2		55-1/4		55-1/4		55-1/2

VERTICAL DETAIL

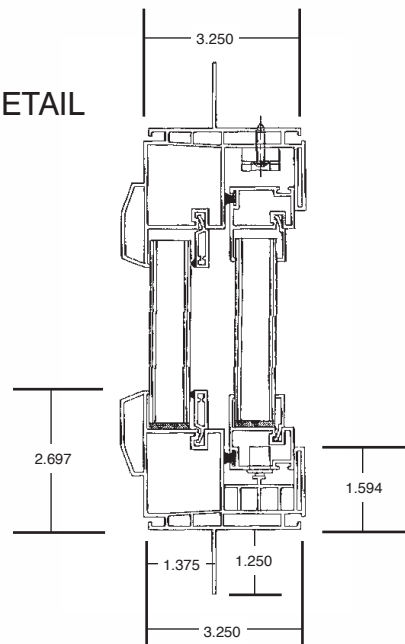

HORIZONTAL DETAIL

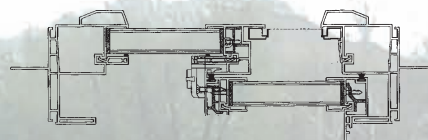

SERIES 1510

Picture Windows & Shapes

Series 1510 Picture Windows and decorative shapes offer great design flexibility along with the benefits of fusion welded frames. These units work equally well when matched and mulled with other Series 1510 products, or as stand-alone units. Custom configurations are readily available.

Applicable Standards:

- Structural: Grade 45

VERTICAL DETAIL



HORIZONTAL DETAIL

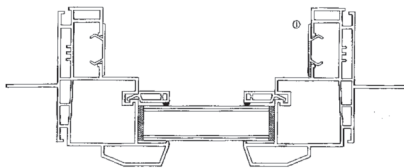

Architectural Shapes



Your imagination isn't limited by the four corners of the window frame -- not with all the available options and accessories such as circle tops, trapezoids & 1/4 circles.

Grid Patterns



Prairie



Traditional



Colonial



Victorian

Standard Sizes

Standard Window Size	Rough Opening		Actual Size		Glass Size	
	Single Unit		Single Unit		Width	Height
	Width	Height	Width	Height		
2020	24	24	23-1/2	23-1/2	19-3/8	19-5/16
2030		36		35-1/2		31-5/16
2040		48		47-1/2		43-5/16
2050		60		59-1/2		55-5/16
3020	36	24	35-1/2	23-1/2	31-3/8	19-5/16
3030		36		35-1/2		31-5/16
3040		48		47-1/2		43-5/16
3050		60		59-1/2		55-5/16
4020	48	24	47-1/2	23-1/2	43-3/8	19-5/16
4030		36		35-1/2		31-5/16
4040		48		47-1/2		43-5/16
4050		60		59-1/2		55-5/16
5020	60	24	59-1/2	23-1/2	55-3/8	19-5/16
5030		36		35-1/2		31-5/16
5040		48		47-1/2		43-5/16
5050		60		59-1/2		55-5/16
6020	72	24	71-1/2	23-1/2	67-5/8	19-5/16
6030		36		35-1/2		31-5/16
2668*	32-3/4	80-3/4	32-1/4	80-1/4	28	76
3068*	38-3/4	80-3/4	38-1/4	80-1/4	34	76
4068*	50-3/4	80-3/4	50-1/4	80-1/4	46	76

*Tempered Glass

Specifications

Scope: Furnish and install all windows of type and size shown on the drawings and called for in the specification including all necessary hardware, anchors, and trim where noted.

General: Windows shall be Columbia Series 1500. Single hung windows shall meet or exceed ASTM D4099 grade 30. Horizontal sliding windows shall meet or exceed ASTM D4099 grade 30.

Material: All frame and sash members shall be manufactured of extruded, high impact resistant, UV-stabilized, rigid virgin polyvinyl chloride (PVC), with nominal .070" masterframe and .065" sash members. Frame members shall be of multi-chambered design. Sill shall contain an internal weeping system for efficient water drainage to the exterior. All exposed weatherstripping, hardware and fasteners shall be stainless steel, aluminum, nylon or other suitable material compatible with rigid PVC. Horizontal sliding windows will contain a drop-in PVC track for convenient cleaning and maintenance.

Construction: All masterframe and sash members shall be miter-cut and fusion-welded. Operable sash of the single hung shall be the tilt-type and the horizontal sliding windows shall be the removable-type. Both shall incorporate fin-type weatherstripping inserted into designed grooves and have continuous contact with frame members when in a closed position.

Glazing: Nominal 7/8" insulating glass shall be double-pane and hermetically sealed meeting ASTM C136 and ASTM E774 level C or higher standards. The sash shall be inside-bead glazed with foam tape on the exterior glazing leg.

Hardware: The operating sash shall have an interlocking rail to provide engagement with the meeting rail when fully closed. Optional positive locking spring-activated latches automatically lock sash when closed. A meeting rail cam lock and keeper will be provided to lock the window in a closed position. Single hung operating sash shall be equipped with counterbalancing mechanisms to hold the sash stationary in any position meeting AAMA 902.2. Balances shall be easily replaceable in the field with the use of hand tools. Horizontal sliding operating sash shall be equipped with nylon slides.

Finish: All window members shall have an integral white or almond color throughout the profile.

Insect Screens: All operating vents shall be designed to receive screens. Screen frames to be aluminum with a baked enamel color to be compatible with PVC frames. 18 x 16 fiberglass cloth meeting ASTM D3656 shall be secured to the frame using a vinyl spline. Screens shall be retained using spring-loaded plungers and shall be removable from inside the building. Insect screens are not for the purpose of providing security or providing for retention of objects or persons from the interior.

Erection and Caulking (by others): All units shall be adequately and securely fastened plumb, level and square without distortion, twisting, bowing or springing of frame members. All frame members shall be properly supported, shimmed, and leveled along their entire length. All units shall be properly caulked using a good grade of non-hardening caulking that is compatible with PVC and the surface it is mounted on to provide a thoroughly water-tight seal meeting AAMA 808.3. The masterframe is to be installed square with the operating sash. The sash should be operated and the masterframe should be given any necessary final adjustment to insure proper operation and weather-tightness.

Lindsborg, KS

(785) 227-3087 • 1-800-255-0174
Fax (785) 227-3002

Iola, KS

(620) 365-3166 • 1-800-362-0503
Fax (620) 365-3168

Pawnee, OK

(918) 762-3001 • 1-800-722-4144
Fax (918) 762-3966



Columbia

Windows & Doors

1600 North Jackson
Kansas City, Missouri 64120

816-241-5800

Toll Free 1-800-892-8703

www.columbiawindows.com

Distributed By:

